

CHARTER CRUISE

EXPLORATION OF JAPAN

Le Jacques-Cartier



THREE DEPARTURE DATES

Itinerary 1 – Overview



Fishing Port / Visit morning market



In the morning, stroll through Miyajima, wrapped in silence



The Port Closest to Mount Fuji

ITINERARY 1

March 13 - 25, 2027

Mar 13	Kobe		
(Departure at 6:00)			
Mar 14	Inujima	●	◆
Mar 15	Mitarai	●	◆
Mar 16	Miyajima	●	◆
Mar 17	Hagi	●	
Mar 18	Busan, South Korea		
Mar 19	Shimonoseki		
Mar 20	At sea		
Mar 21	Katsuura	●	★
Mar 22	Toba	●	
Mar 23	Yaizu		★
Mar 24	Taganoura		★
Mar 25	Yokohama		
(Arrive at 22:00)			

- = Zodiac Landing
- = Tender Boat Transfer
- ★ = Maiden Call
- ◆ = port to explore on foot

THREE DEPARTURE DATES

Itinerary 1-A•1-B – Overview



Fishing Port / Visit morning market



1-A route
(5nights6
days)

ITINERARY 1

March 13 - 25, 2027

Mar 13	Kobe	
(Departure at 6:00)		
Mar 14	Inujima	● ◆
Mar 15	Mitarai	● ◆
Mar 16	Miyajima	● ◆
Mar 17	Hagi	●
Mar 18	Busan, South Korea	
Mar 19	Shimonoseki	
Mar 20	At sea	
Mar 21	Katsuura	● ★
Mar 22	Toba	●
Mar 23	Yaizu	★
Mar 24	Tagonoura	★
Mar 25	Yokohama	
(Arrive at 22:00)		

1-B route
(7nights8
days)

1-B route

BUSAN, SOUTH KOREA

1-A route

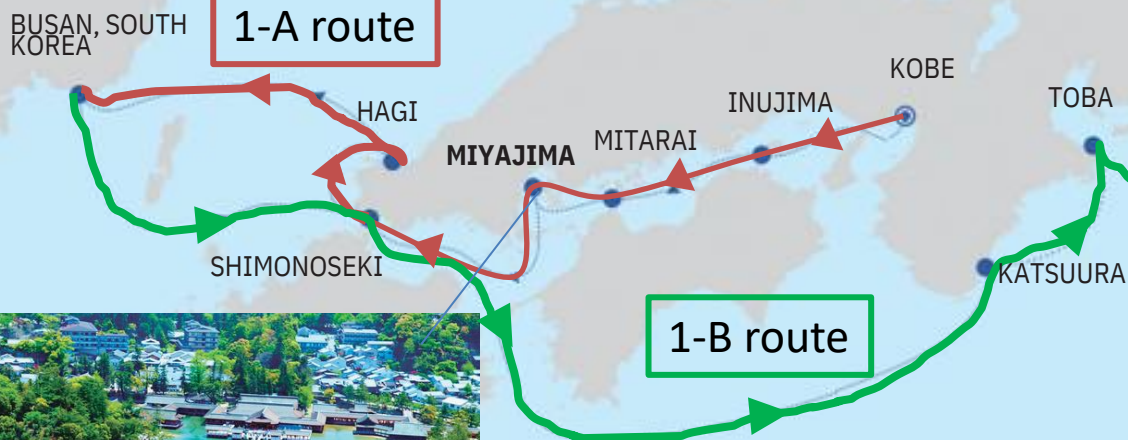

In the morning, stroll through Miyajima, wrapped in silence

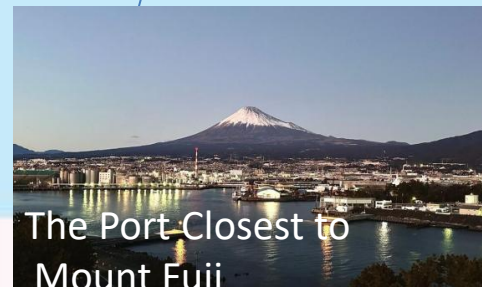

The Port Closest to Mount Fuji

- = Zodiac Landing
- = Tender Boat Transfer
- ★ = Maiden Call
- ◆ = port to explore on foot

THREE DEPARTURE DATES

Itinerary 2 – Overview



In the morning, stroll through Miyajima, wrapped in silence



The Port Closest to Mount Fuji

ITINERARY 2

March 25 - April 6, 2027

- Mar 25 Yokohama
(Departure at 19:00)
- Mar 26 Tagonoura ★
- Mar 27 Yaizu ★
- Mar 28 Toba ●
- Mar 29 Katsuura ● ★
- Mar 30 At sea
- Mar 31 Hagi ●
- Apr 01 Busan, South Korea
- Apr 02 Shimonoseki
- Apr 03 Miyajima ● ◆
- Apr 04 Mitarai ● ◆
- Apr 05 Inujima ● ◆
- Apr 06 Kobe

- = Zodiac Landing
- = Tender Boat Transfer
- ★ = Maiden Call
- ◆ = port to explore on foot

THREE DEPARTURE DATES

Itinerary 2-A • 2-B – Overview



In the morning, stroll through Miyajima, wrapped in silence



**2-A route
(7nights 8days)**

**2-B route
(5nights 6days)**

March 25 - April 6, 2027

Mar 25	Yokohama	
	(Departure at 19:00)	
Mar 26	Tagonoura	★
Mar 27	Yaizu	★
Mar 28	Toba	●
Mar 29	Katsuura	● ★
Mar 30	At sea	
Mar 31	Hagi	●
Apr 01	Busan, South Korea	
Apr 02	Shimonoseki	
Apr 03	Miyajima	● ◆
Apr 04	Mitarai	● ◆
Apr 05	Inujima	● ◆
Apr 06	Kobe	

● = Zodiac Landing
● = Tender Boat Transfer
★ = Maiden Call
◆ = port to explore on foot

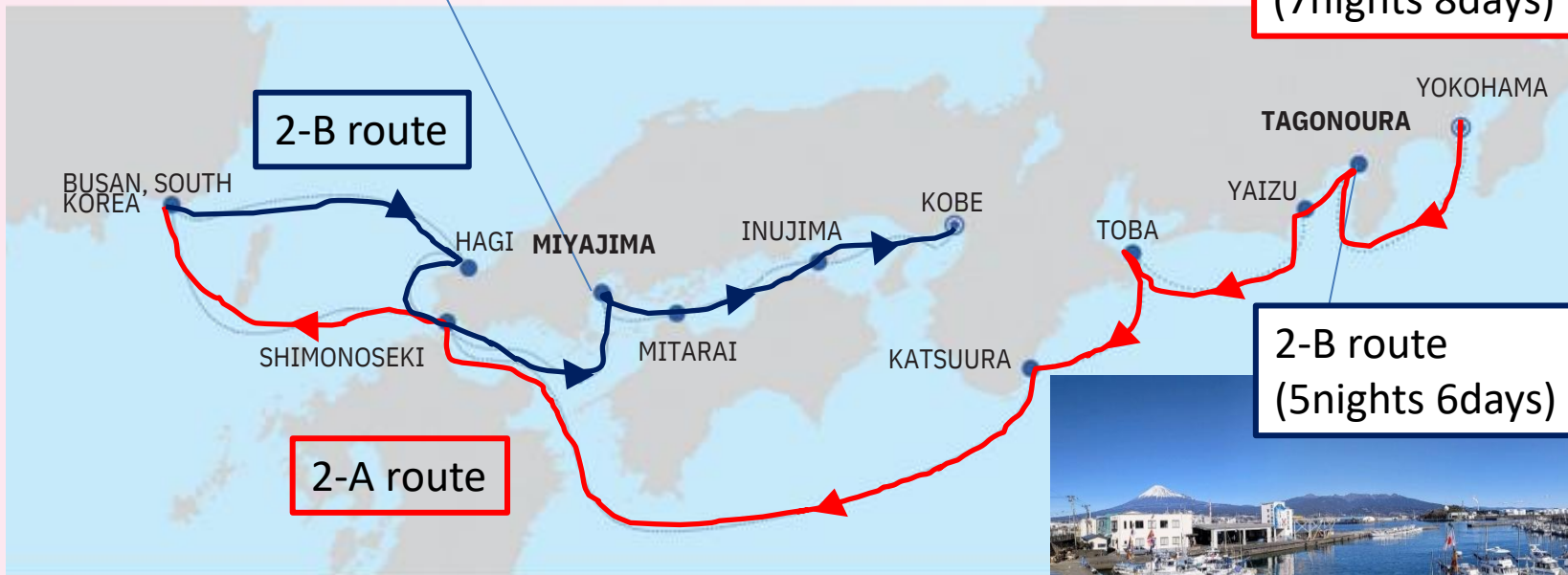

5

Tagonoura /
The Port Closest to Mount Fuji

THREE DEPARTURE DATES

Itinerary 3 – Overview



Private Cocktail Party at Kumamoto Castle



Observation of a Tuna Cutting

April 6 - 18, 2027

- Apr 06 Kobe
(Departure at 22:00)
- Apr 07 Inujima ● ◆
- Apr 08 Mitarai ● ◆
- Apr 09 Miyajima ● ◆
- Apr 10 Hagi ●
- Apr 11 Tsushima ●
- Apr 12 Busan, South Korea
- Apr 13 Nagasaki
- Apr 14 Yakushima
- Apr 15 Koshikijima ●
- Apr 16 Iki ●
- Apr 17 Amakusa ● ◆
- Apr 18 Kumamoto
(Arrive at 6:00)

- = Zodiac Landing
- = Tender Boat Transfer
- ◆ = port to explore on foot

THREE DEPARTURE DATES

Itinerary 3-A • 3-B– Overview



3-A route

3-A route
(6nights 7days)

3-B route

3-B route
(6nights 7days)



Observation of a Tuna Cutting



Private Cocktail Party at Kumamoto Castle

April 6 - 18, 2027

- Apr 06 Kobe
(Departure at 22:00)
- Apr 07 Inujima ● ◆
- Apr 08 Mitarai ● ◆
- Apr 09 Miyajima ● ◆
- Apr 10 Hagi ●
- Apr 11 Tsushima ●
- Apr 12 Busan, South Korea
- Apr 13 Nagasaki
- Apr 14 Yakushima
- Apr 15 Koshikijima ●
- Apr 16 Iki ●
- Apr 17 Amakusa ● ◆
- Apr 18 Kumamoto
(Arrive at 6:00)

- = Zodiac Landing
- = Tender Boat Transfer
- ◆ = port to explore on foot

Embark on the Expedition Cruise Ship “Le Jacques Cartier”



 PONANT Le Jacques Cartier

Ship Specifications

- Gross Tonnage: 9,900 tons
- Crew: 118
- Cabins: 92
- Passenger Capacity: 184 guests
- Overall Length: 131 meters
- Beam: 18 meters
- Year Entered Service: 2020

■ Characteristics of Cruise Ship Classes

Primary customer base : Mainly affluent retirees aged 60+

Duration : Over 10 nights to 2 weeks

Ship Characteristics : Small luxury vessels,

All-inclusive, Carrying fewer than 200 to 500 passengers, including exploration ships

Navigation area : Polar Regions and Remote Islands and Hidden Lands

Boutique Class



Primary customer base : Starts from 40s, mainly 50+

Duration : Mostly longer than 10 nights

Ship Characteristics : Medium to large

luxury ships, often over 1,000 passengers

More meticulous service than premium ships

Navigation area : Sail the best waters during the best season

Luxury Class



Primary customer base : Mainly guests aged 30+

Duration : Mostly around 7 to 10 nights

Ship Characteristics : Ships around 100,000 GT,

often over 1,000 passengers,

has an elegance not found on casual vessels

Navigation area : Popular cruise destinations worldwide

Premium Class



Primary customer base : Younger travelers and families

Duration : Mostly fixed-point cruises of 3-7 nights

Ship Characteristics : Mega ships over 100,000 GT,

often over 2,000-3,000

passengers

Highly leisure and entertainment - oriented



Navigation area : Assigned to a single location and sail throughout the year

Casual Class



Hankyu Travel Charters vs. Other Companies

Between 2023 and 2025, approximately 6,000 passengers from around the world joined PONANT's Japan cruises. Of these, 3,000 passengers traveled on charter products operated by A&K and TAUCK. Hankyu Travel offers cruise tours that are in no way inferior to those of major charter operators, and in fact provides even more comprehensive cruise experience.

Charterer	A & K	Hankyu Travel	TAUCK
Duration	11 nights cruise + 2 nights hotel	12 nights cruise (Pre/post-cruise extensions available upon request)	8 nights cruise + 5 nights hotel
Price	23,195USD~ ≒3,610,000JPY~	2,500,000JPY~ ≒16,000USD~	16,000USD~ ≒2,500,000JPY~
Vessel	 <p>Le Jacques Cartier (Commissioned in 2020) PONAN One of PONANT's Explorer series ships. This ship is equipped with Zodiac boats, allowing guests to enjoy an expedition cruise focused on ports of call that are accessible only to smaller vessels. Features the "Blue Eye" underwater lounge for an immersive undersea experience.</p>		 <p>Le Soléal (Commissioned in 2013) One of PONANT's Sistership series. No underwater lounge on board.</p>

*Exchange rates are as of January 2026.

What Makes Ponant's Le Jacques Cartier Different from Other Luxury Cruises

1

The only exploration trip in Japan that uses Zodiac boats



These high-performance boats can reach small islands and other remote areas. We have naturalists on board to ensure a safe and comfortable experience.

Even small hidden ports, coves, and beaches inaccessible to large cruise ships—or even tender boats—are within reach with Le Jacques Cartier's Zodiac boats, taking you on unforgettable adventures.

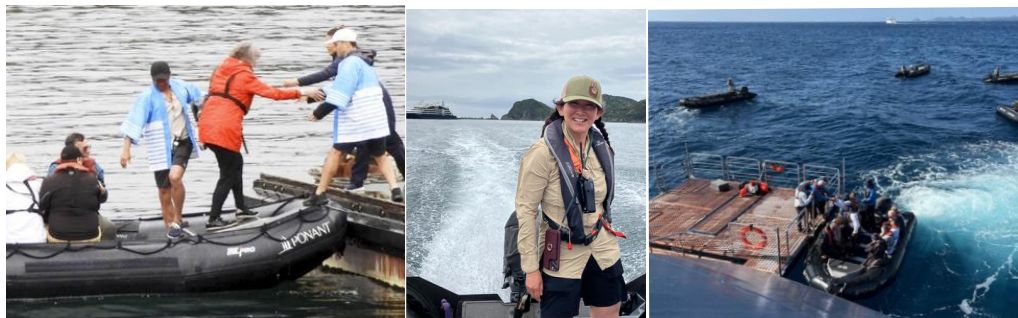

2

Meet Our Naturalists



ALIZÉ RIEU



LAURENT LAVOREL



RYO IJICHI



NOZOMI TAKEYABU



MARTIN KRUMPER



OLIVIER DELCROIX

Flora & Fauna

Astronomy

Geology

Marine Science

A team of naturalists, with extensive knowledge as nature guides, is onboard to introduce the wonders of the local environment, wildlife, and plants at each port of call and during the voyage. They accompany Zodiac boat landings, enriching your exploration with insightful commentary. Onboard, seminars are planned to further enhance your understanding and enjoyment of the natural world.



Seminars led by our naturalists are planned onboard.

What Makes Ponant's Le Jacques Cartier Different from Other Luxury Cruises

3

Supervised by Michelin-starred chef Alain Ducasse through Ducasse Conseil, this is like a starred restaurant at sea.



Savor gourmet French cuisine, inspired by the elegance of each port of call. Fresh, carefully selected ingredients, aged cheeses, and grand cru wines make every meal a memorable delight.

Exclusive Ports of Call & Onboard Experiences Curated by Hankyu

Featuring Destination Specialists Who Know Japan Inside Out

1

Onboard Sushi Performance by a Master Chef

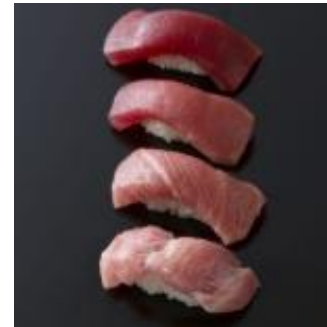

Yoshinori Tezuka (Yoshi)

4th-generation owner of Matsunozushi, founded in 1910. Conducted private sushi caterings all over the world, including the U.S. and Europe.

Notable achievements include serving sushi as a guest of the British Royal Family and producing the First Ladies' Sushi Luncheon at the 2019 G20 Osaka Summit.



Yoshi, the fourth-generation owner of Matsunozushi, will join this special cruise to showcase the art of sushi. Beyond serving exquisite flavors, Yoshi is a global ambassador of Japanese culture, sharing the deep spirit and heritage of Japan through live demonstrations worldwide. This is more than a meal; it is an opportunity to deepen your understanding of Japanese culinary traditions and create unforgettable travel memories.

Exclusive Ports of Call & Onboard Experiences Curated by Hankyu
Featuring Destination Specialists Who Know Japan Inside Out

2 Exclusive Auction Viewing at Japan's Top Fishing Port and
"Bara-sushi" Performance



Profile: Naoki Maeda

Born in 1974 in Yaizu City, Shizuoka Prefecture
5th-generation owner of "Sasue Maeda Fish Shop," a long-established establishment with over 60 years of history in Yaizu, which boasts the highest landing value in Japan. His exceptional skills in cleaning and preparing fish have been frequently featured on television programs and in renowned magazines. His clientele includes numerous Michelin three-star chefs who trust his expertise.。

At Yaizu Port, one of Japan's leading fishing hubs, you can witness the live auctions of freshly landed seafood. While these auctions are typically closed to the public, this cruise offers an exclusive viewing experience just for our guests. After experiencing the dynamic atmosphere of diverse fish being auctioned off amidst the spirited shouts of local fishermen, the selected catch will be brought back to the ship. In the onboard theater, you will enjoy a live performance as the fish is transformed into beautiful sushi, which will be served for your lunch.

Exclusive Ports of Call & Onboard Experiences Curated by Hankyu
Featuring Destination Specialists Who Know Japan Inside Out

3 Exclusive Cocktail Party at the Iconic Kumamoto



Kumamoto Castle, the pride of Kumamoto Prefecture, is a location of profound significance. It is designated as a National Special Historic Site, and its 400-year-old turrets (yagura), gates, and walls are recognized as National Important Cultural Properties. On the final evening of the third cruise segment, you will enjoy a farewell cocktail party held at the foot of the castle. Surrounded by the castle's elegant white architecture rising above the lush grounds, you will be treated to a series of live performances, creating an unforgettable conclusion to your journey.

Exclusive Ports of Call & Onboard Experiences Curated by Hankyu Featuring Destination Specialists Who Know Japan Inside Out

4

A variety of experiences at carefully selected ports of call



At the carefully selected ports of call, you will not only witness Japan's cultural heritage and beautiful scenery, but you will also enjoy unique and precious experiences thanks to the collaboration between **Hankyu Travel International** and local governments—experiences unavailable on other cruises.

For example, you will be able to observe a fresh tuna cutting demonstration right after the catch is landed. What's more, the tuna will then be expertly prepared by skilled artisans and served exclusively onboard **Le Jacques Cartier** for our guests. . A highlight is the onboard “SAKE Relay,” where you can enjoy carefully selected sake from local breweries at the ship’s bar. After exploring charming destinations during the day, return to the ship to taste regional sake without visiting a distillery—a truly special experience unique to Hankyu Charter Cruises. In addition, at each port of call, guests will be welcomed with heartfelt hospitality from the entire community, including local traditional cultural experiences and cuisine made with regional ingredients.

Onboard Facilities

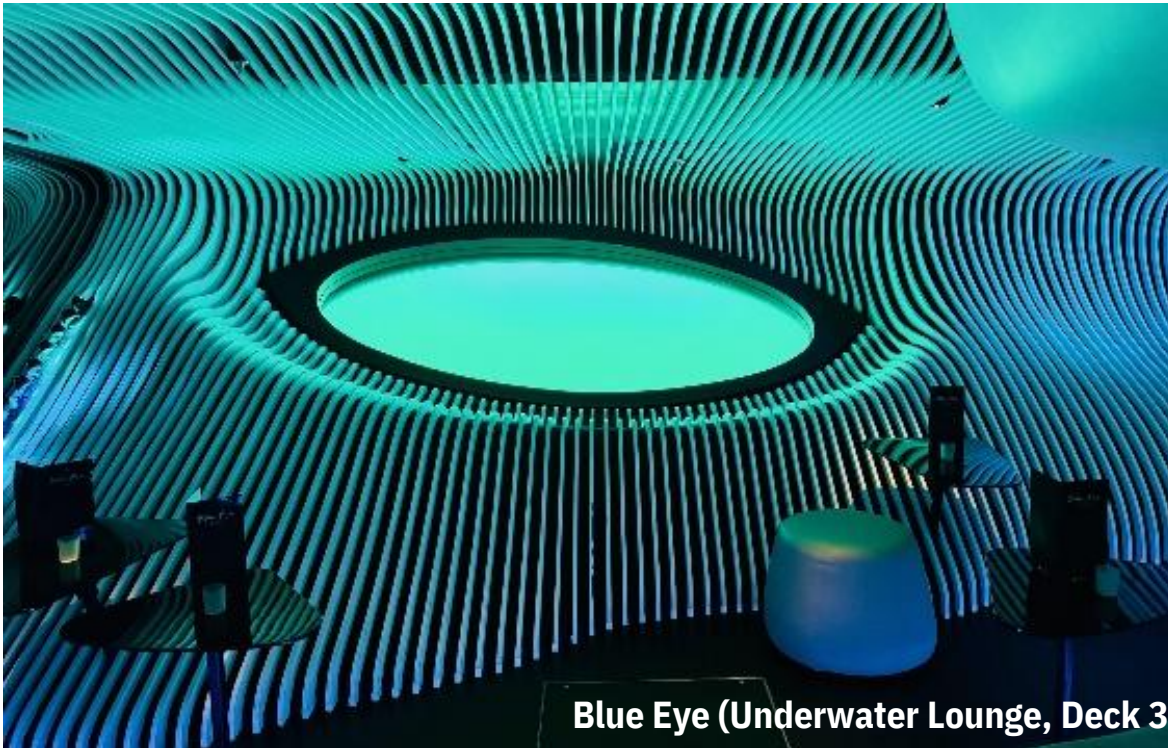

The lounge located on the underwater floor features large transparent windows, allowing you to view the scene beneath the sea surface. In highly transparent waters, you may be able to gaze at swimming fish and coral reefs, or even experience interacting with dolphins through the window.

At night, the lights around the windows turn on, making it a popular, moody lounge where you can watch the fish passing by.

17

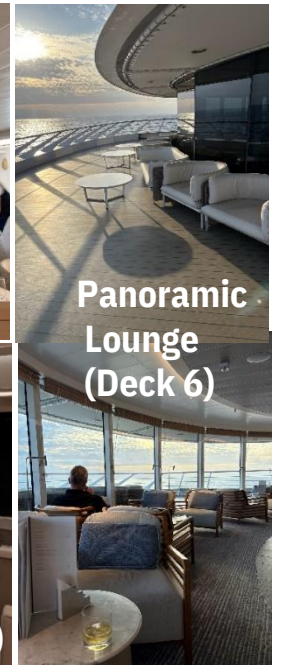

Additional Facilities:
Shop, Outdoor Pool, Medical Center (Deck 3)

Guest Room Amenities

- 24-hour room service
- Mini-bar
- Internet access (Wi-Fi) (available depending on sailing area and location)
- Air conditioning (adjustable in each room)
- Dresser, bathrobe, hair dryer
- French brand toiletries
- Nespresso coffee machine
- In-room safe
- Telephone
- Bose™ Bluetooth speaker
- LCD TV with video-on-demand
- 110V power outlet (Type A, two flat pins)
- 220V power outlet (Type C, two round pins)
- 2 ADA (accessible) cabins

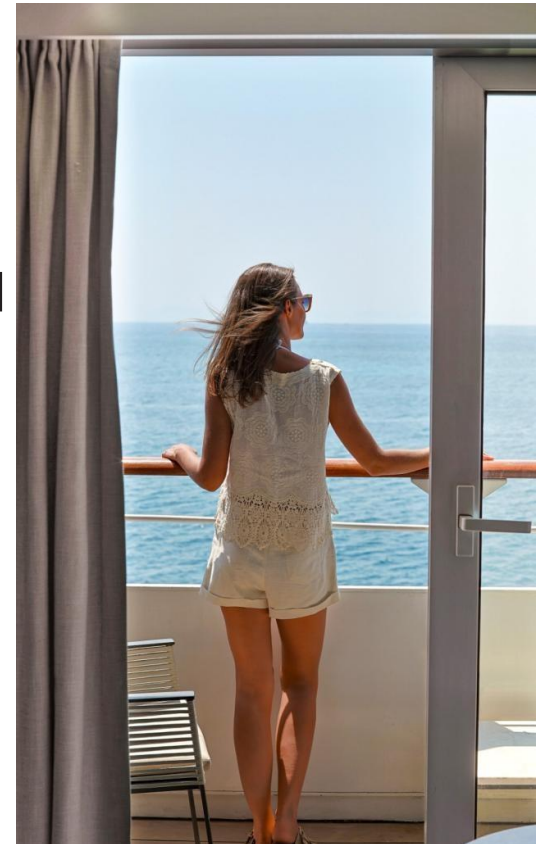

< Prices JPY >

The cruise fare is all-inclusive, covering the following: the cruise fee, port excursions, all meals onboard, and drinks (alcoholic and non-alcoholic beverages)

12nights 13days (Itinerary1・2・3)

Cabins and Suites	Max. Occupancy	Number	Cabin Size	Price *The price is per person (2 persons per room)	Price *The price is per person (1 person per room)
Owner's Suite (OS)	4	2	45sqm	¥ 6,900,000	¥ 12,420,000
Grand Deluxe Suite (GD)	4	2	45sqm	¥ 6,600,000	¥ 11,880,000
Privilege Suite (PV)	3	4	32sqm	¥ 6,300,000	¥11,340,000
Prestige Suite Deck 6 (PR6)	4	~5	38sqm	¥ 6,000,000	¥10,800,000
Prestige Suite Deck 5 (PR5)	4	~13	38sqm	¥ 6,000,000	¥10,800,000
Deluxe Suite (DS)	3	5	27sqm	¥ 4,300,000	¥7,740,000
Prestige Stateroom Deck 6 (PR6)	2	4~14	19sqm	¥ 3,100,000	¥5,580,000
Prestige Stateroom Deck 5 (PR5)	2	3~29	19sqm	¥ 2,900,000	¥5,220,000
Prestige Stateroom Deck 4 (PR4)	2	23	19sqm	¥ 2,900,000	¥5,220,000
Deluxe Stateroom (DEL)	2	13	19sqm	¥ 2,500,000	¥4,500,000

*Pristige Stateroom can be used as a connecting room

When 3 to 4 people share a room, the 3rd and 4th persons receive a 50% discount on the travel fee.

(Available for Suite-type cabins only. Discounts do not apply for 3 to 4 persons sharing a single room via connecting rooms.

Extra beds consist of converting the existing sofa into a bed.)

*Prices do not include: Crew gratuities, pre- and post-cruise excursions, pre- and post-cruise accommodation, or port transfers

< Prices JPY >

The cruise fare is all-inclusive, covering the following: the cruise fee, port excursions, all meals onboard, and drinks (alcoholic and non-alcoholic beverages)

5nights 6days (Itinerary1-A • 2-B)

Cabins and Suites	Max. Occupancy	Number	Cabin Size	Price <small>*The price is per person (2 persons per room)</small>	Price <small>*The price is per person (1 person per room)</small>
Owner's Suite (OS)	4	2	45sqm	¥ 2,875,000	¥ 12,420,000
Grand Deluxe Suite (GD)	4	2	45sqm	¥ 2,750,000	¥ 11,880,000
Privilege Suite (PV)	3	4	32sqm	¥ 2,625,000	¥11,340,000
Prestige Suite Deck 6 (PR6)	4	~5	38sqm	¥ 2,500,000	¥10,800,000
Prestige Suite Deck 5 (PR5)	4	~13	38sqm	¥ 1,792,000	¥10,800,000
Deluxe Suite (DS)	3	5	27sqm	¥ 1,792,000	¥7,740,000
Prestige Stateroom Deck 6 (PR6)	2	4~14	19sqm	¥ 1,292,000	¥5,580,000
Prestige Stateroom Deck 5 (PR5)	2	3~29	19sqm	¥ 1,209,000	¥5,220,000
Prestige Stateroom Deck 4 (PR4)	2	23	19sqm	¥ 1,209,000	¥5,220,000
Deluxe Stateroom (DEL)	2	13	19sqm	¥ 1,042,000	¥4,500,000

*Pristige Stateroom can be used as a connecting room

When 3 to 4 people share a room, the 3rd and 4th persons receive a 50% discount on the travel fee.

(Available for Suite-type cabins only. Discounts do not apply for 3 to 4 persons sharing a single room via connecting rooms.

Extra beds consist of converting the existing sofa into a bed.)

*Prices do not include: Crew gratuities, pre- and post-cruise excursions, pre- and post-cruise accommodation, or port transfers

< Prices JPY >

The cruise fare is all-inclusive, covering the following: the cruise fee, port excursions, all meals onboard, and drinks (alcoholic and non-alcoholic beverages)
7nights 8days (Itinerary1-B・2-A)

Cabins and Suites	Max. Occupancy	Number	Cabin Size	Price <small>*The price is per person (2 persons per room)</small>	Price <small>*The price is per person (1 person per room)</small>
Owner's Suite (OS)	4	2	45sqm	¥ 4,025,000	¥ 7,245,000
Grand Deluxe Suite (GD)	4	2	45sqm	¥ 3,850,000	¥ 6,930,000
Privilege Suite (PV)	3	4	32sqm	¥ 3,675,000	¥6,615,000
Prestige Suite Deck 6 (PR6)	4	~5	38sqm	¥ 3,500,000	¥6,300,000
Prestige Suite Deck 5 (PR5)	4	~13	38sqm	¥ 3,500,000	¥6,300,000
Deluxe Suite (DS)	3	5	27sqm	¥ 2,509,000	¥4,515,000
Prestige Stateroom Deck 6 (PR6)	2	4~14	19sqm	¥ 1,809,000	¥3,255,000
Prestige Stateroom Deck 5 (PR5)	2	3~29	19sqm	¥ 1,692,000	¥3,045,000
Prestige Stateroom Deck 4 (PR4)	2	23	19sqm	¥ 1,692,000	¥3,045,000
Deluxe Stateroom (DEL)	2	13	19sqm	¥ 1,459,000	¥2,625,000

*Pristige Stateroom can be used as a connecting room

When 3 to 4 people share a room, the 3rd and 4th persons receive a 50% discount on the travel fee.

(Available for Suite-type cabins only. Discounts do not apply for 3 to 4 persons sharing a single room via connecting rooms.

Extra beds consist of converting the existing sofa into a bed.)

*Prices do not include: Crew gratuities, pre- and post-cruise excursions, pre- and post-cruise accommodation, or port transfers

< Prices JPY >

The cruise fare is all-inclusive, covering the following: the cruise fee, port excursions, all meals onboard, and drinks (alcoholic and non-alcoholic beverages)
6nights 7days (Itinerary3-A • 3-B)

Cabins and Suites	Max. Occupancy	Number	Cabin Size	Price *The price is per person (2 persons per room)	Price *The price is per person (1 person per room)
Owner's Suite (OS)	4	2	45sqm	¥ 3,450,000	¥ 6,210,000
Grand Deluxe Suite (GD)	4	2	45sqm	¥ 3,300,000	¥ 5,940,000
Privilege Suite (PV)	3	4	32sqm	¥ 3,150,000	¥5,670,000
Prestige Suite Deck 6 (PR6)	4	~5	38sqm	¥ 3,000,000	¥5,400,000
Prestige Suite Deck 5 (PR5)	4	~13	38sqm	¥ 3,000,000	¥5,400,000
Deluxe Suite (DS)	3	5	27sqm	¥ 2,150,000	¥3,870,000
Prestige Stateroom Deck 6 (PR6)	2	4~14	19sqm	¥ 1,550,000	¥2,790,000
Prestige Stateroom Deck 5 (PR5)	2	3~29	19sqm	¥ 1,450,000	¥2,610,000
Prestige Stateroom Deck 4 (PR4)	2	23	19sqm	¥ 1,450,000	¥ 2,610,000
Deluxe Stateroom (DEL)	2	13	19sqm	¥ 1,250,000	¥2,250,000

*Pristige Stateroom can be used as a connecting room

When 3 to 4 people share a room, the 3rd and 4th persons receive a 50% discount on the travel fee.

(Available for Suite-type cabins only. Discounts do not apply for 3 to 4 persons sharing a single room via connecting rooms.

Extra beds consist of converting the existing sofa into a bed.)

*Prices do not include: Crew gratuities, pre- and post-cruise excursions, pre- and post-cruise accommodation, or port transfers

Owner's Suite

45 m² + Private Terrace 40 m²
(Jacuzzi with sliding bay window)



Grand Deluxe Suite

45 m² + Private Terrace 30 m²
with sliding bay window



Privilege Suite



32 m² + Private Balcony 8 m²
with sliding bay window

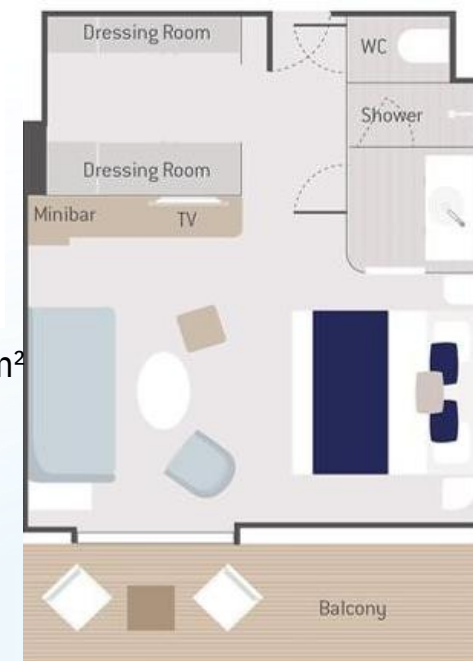

Prestige Suite

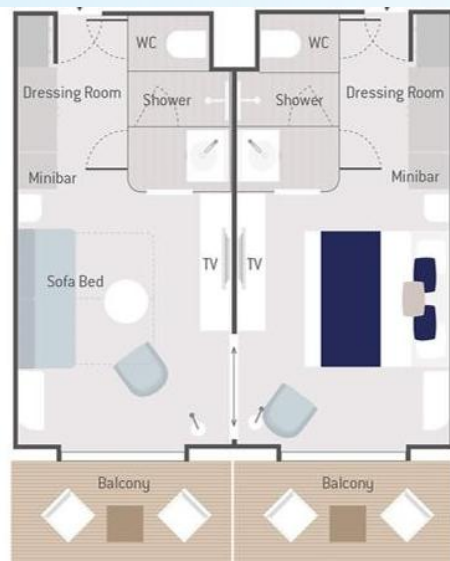

38 m² + Private Balcony 8 m²
with sliding bay window



Deluxe Suite

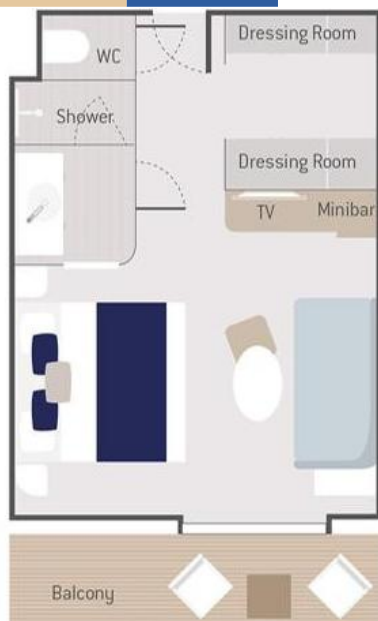

27.5 m² + Private Balcony
4–6 m² with sliding bay
window



Prestige Stateroom

19 m² + Private Balcony 4 m²
with sliding bay window

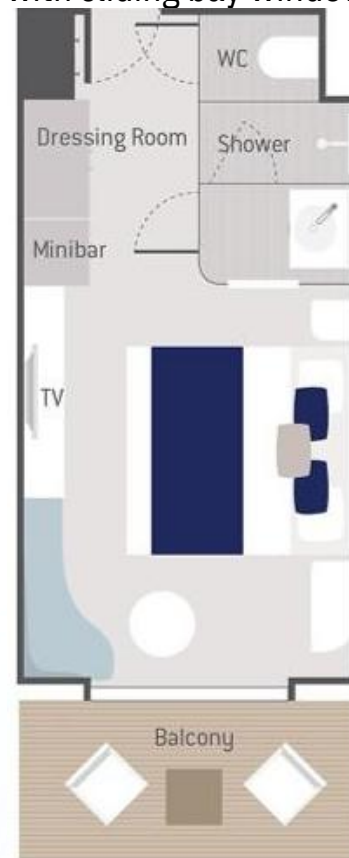

Deluxe Stateroom

19 m² + Private Balcony 4 m²

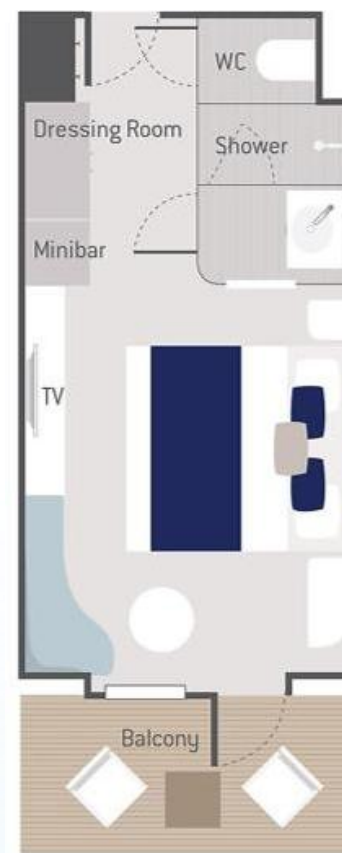

Onboard Map

Deck3



Deck4



Deck5



Deck6

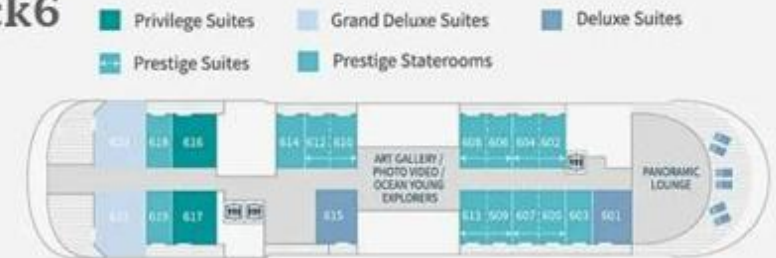

Deck7



Sales Terms

[Deposit & Final Payment]

- Deposit: 25% of the total cruise fare
- Final payment: 90 days prior to cruise departure

[Cancellation Fees]

- **Within 14 days of the date of Conclusion of the Contract (reservation completion date): no cancellation fees**

From 15 days after the date of Conclusion of the Contract to 365 days before the cruise departure: JPY 25,000 per passenger per cruise

From 364 days to 211 days before the cruise departure: 10% of the cruise fare

From 210 days to 91 days before the cruise departure: 25% of the cruise fare

Less than 91 days before the cruise departure: 100% of the cruise fare



HANKYU TRAVEL

INTERNATIONAL CO., LTD.

Contact Information

International Sales Department, International
Travel Business Headquarters, Hankyu Travel
International Co., Ltd.

Tel : +81-3-6745-7357

Fax : +81-3-6745-7347

Email : luxury-hankyu@hei.hankyu.co.jp

PIC : Shoko Inoguchi, Makoto Yasugi

✕Feel free to contact us by email in English

The English website is available here



<https://luxury-hankyu.com/>

Please download the eBook here



<https://www.hankyu-travel.com/english/e-book/>

Media Library is here



<https://bit.ly/HankyuPONANT>